

Profiler®

Series 2000 Linear Drive or 2000B Belt Drive System



For An Aesthetic And Rugged Automatic Entrance Solution

The Horton-exclusive drive systems feature a slim 4" x 6" header that allows for a flush installation to 4" jambs and quick header-to-jamb fastening with no header end caps required. This results in attractive sight-lines with hair-line joints.

Exclusive standard system features:

- Heavy duty drive-train with 1/8 HP motor and choice of gearless linear drive system or belt drive system
- High quality steel carriage wheels with ball bearing design
- Fully replaceable nylon covered aluminum carriage track
- Patented panic breakout system featuring a solid bar wheel carriage with continuous interlocking. This ensures dependable emergency breakout without sagging, along with effortless resetting.
- Adjustable astragal with double weatherseal captured in door panel extrusion. This ensures lasting and superior weatherseal.
- Superior high-strength corner block construction for all door panels for years of dependable service



Specify Horton and demand AAADM certified installation

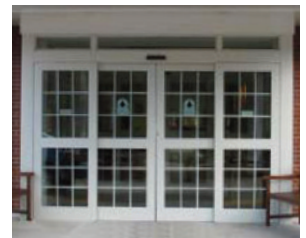

Custom Applications & Options

- Transom with glass division
- Additional horizontal rails & vertical stiles
- Narrow, medium & wide stile construction
- Glass stops for 1/4" to 1" glazing

Additional Features/Benefits

- Available in a variety of anodized, paint or clad finishes
- Accommodates slide panels up to 200 lbs.
- Exclusive dual safety beams for added threshold protection
- Microprocessor control with built-in diagnostics
- Selectable operating modes
- Easily adjustable opening & closing speeds
- Manual operation in case of power failure

Did You Know?



The Horton Profiler Series 2000 was the first automatic slide door in America.



Profiler®

Series 2000 Linear Drive or 2000B Belt Drive System

Door units are typically actuated with header mounted sensor at interior & exterior for detection of traffic in each direction. Door closes after time delay expires. Remote control or security system actuation are available.

Installation and Operation

Electrical Requirements:

120, 220 VAC, 50 - 60 Hz,
single phase, 15 amp service.
Current draw - 3.15 amps.



Breakaway Slide Panels

Compliant with NFPA 101
& ANSI A156.10

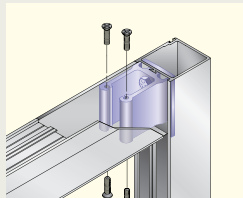

Corner Block Design

Exclusive mortise-style corner block construction is far superior to mass produced panels with thru-bolt construction.

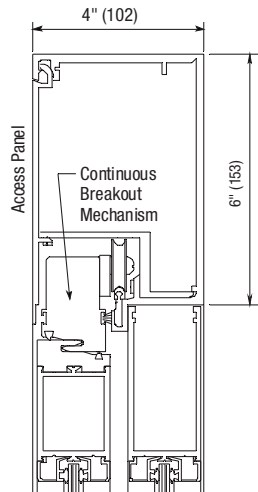

Header Vertical Section

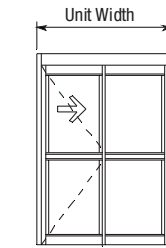

Type SX-0 (O-SX Opposite)

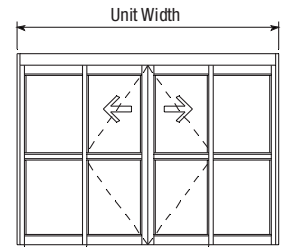
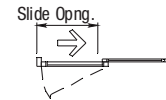

Type O-SX-SX-0

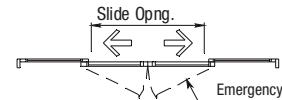

Type 110

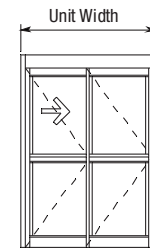

Type SX-S0 (S0-SX Opposite)

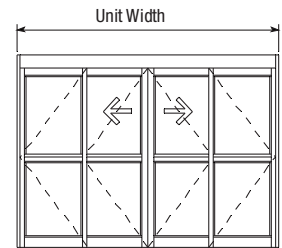
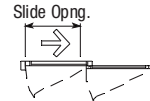

Type S0-SX-SX-S0

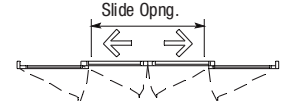

Type 310

Selection Guide

Model	Unit Width	Maximum Slide Opening	Breakout Opening	
			Type 110	Type 310
Single Slide	7'-0" (2134)	3'-0" (914)	3'-3 1/2" (1003)	6'-3" (1905)
	8'-0" (2438)	3'-6" (1067)	3'-9 1/2" (1156)	7'-3" (2210)
	8'-6" (2591)	3'-9" (1143)	4'-0 1/2" (1232)	7'-9" (2362)
	9'-0" (2743)	4'-0" (1219)	4'-3 1/2" (1308)	8'-3" (2515)
Bi-part	8'-0" (2438)	3'-0" (914)	3'-7" (1092)	6'-9 1/2" (2070)
	9'-0" (2743)	3'-6" (1067)	4'-1" (1245)	7'-9 1/2" (2375)
	10'-0" (3048)	4'-0" (1219)	4'-7" (1397)	8'-9 1/2" (2680)
	12'-0" (3658)	5'-0" (1524)	5'-7" (1702)	10'-9 1/2" (3289)
	14'-0" (4267)	6'-0" (1829)	6'-7" (2007)	12'-9 1/2" (3899)
	16'-0" (4877)	7'-0" (2134)	7'-7" (2311)	14'-9 1/2" (4509)



Horton Automatics
World Headquarters
4242 Baldwin Boulevard
Corpus Christi, Texas 78405-3399 USA
Phone: 800-531-3111, 361-888-5591
Fax: 361-888-6510
www.hortondoors.com

Horton Automatics, Ltd.
United Kingdom
Unit A, Hortonwood 31
Telford, Shropshire, England TF1-7YZ
Phone: 01952 670169
Fax: 01952 670181



A Division of
Overhead Door Corporation
A Sanwa Shutter Company